

HOOD Z-AF

- Ensures trouble-free operation of fans on rooftops.
- Made of steel with a polymer coating.

| Model | Dimensions [mm] | | | | | | | | | Weight [kg] |
|-----------|-----------------|-----|------|------|------|------|------|-----|----|-------------|
| | H | H1 | A | B | Ø D | Ø D1 | Ø D2 | Ø d | n | |
| Z-AF-400 | 319 | 350 | 612 | 705 | 400 | 450 | 490 | 8 | 12 | 10 |
| Z-AF-450 | 319 | 350 | 672 | 774 | 450 | 500 | 540 | 8 | 12 | 11 |
| Z-AF-500 | 350 | 395 | 742 | 854 | 500 | 560 | 600 | 12 | 12 | 14 |
| Z-AF-560 | 350 | 380 | 790 | 910 | 560 | 620 | 660 | 12 | 12 | 16 |
| Z-AF-630 | 359 | 404 | 860 | 991 | 630 | 690 | 730 | 12 | 12 | 20 |
| Z-AF-710 | 420 | 456 | 988 | 1139 | 710 | 770 | 810 | 12 | 16 | 31 |
| Z-AF-800 | 475 | 511 | 1072 | 1236 | 800 | 860 | 900 | 12 | 16 | 42 |
| Z-AF-900 | 527 | 572 | 1189 | 1370 | 900 | 970 | 1015 | 15 | 16 | 57 |
| Z-AF-1000 | 640 | 685 | 1404 | 1618 | 1000 | 1070 | 1115 | 15 | 16 | 83 |
| Z-AF-1120 | 655 | 700 | 1552 | 1789 | 1120 | 1190 | 1270 | 15 | 20 | 99 |
| Z-AF-1250 | 685 | 730 | 1707 | 1968 | 1250 | 1320 | 1400 | 15 | 20 | 115 |

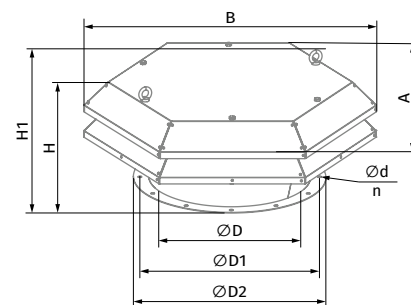

ROOF ADAPTER PK-AF*

- Used for mounting **Axis-P** on rooftops.
- Made of steel with a polymer coating.

| Model | Dimensions [mm] | | | | | | | | | | Weight [kg] |
|------------|-----------------|------|------|----|-----|----|----|------|------|-----|-------------|
| | ØD | ØD1 | ØD2 | Ød | Ød1 | n | n1 | A | B | H | |
| PK-AF-400 | 400 | 450 | 490 | 8 | 7 | 12 | 6 | 580 | 701 | 170 | 17.5 |
| PK-AF-450 | 450 | 500 | 540 | 8 | 7 | 12 | 6 | 580 | 701 | 170 | 16.5 |
| PK-AF-500 | 500 | 560 | 600 | 12 | 11 | 12 | 6 | 640 | 770 | 170 | 20.3 |
| PK-AF-560 | 560 | 620 | 660 | 12 | 11 | 12 | 6 | 750 | 920 | 170 | 27.2 |
| PK-AF-630 | 630 | 690 | 730 | 12 | 11 | 12 | 6 | 750 | 920 | 170 | 25.5 |
| PK-AF-710 | 710 | 770 | 810 | 12 | 11 | 16 | 8 | 980 | 1150 | 290 | 53.0 |
| PK-AF-800 | 800 | 860 | 900 | 12 | 11 | 16 | 8 | 980 | 1150 | 290 | 51.1 |
| PK-AF-900 | 900 | 970 | 1015 | 15 | 13 | 16 | 8 | 1050 | 1220 | 290 | 54.5 |
| PK-AF-1000 | 1000 | 1070 | 1115 | 15 | 13 | 16 | 8 | 1340 | 1510 | 340 | 93.4 |
| PK-AF-1120 | 1120 | 1190 | 1270 | 15 | 13 | 20 | 10 | 1340 | 1510 | 340 | 91.3 |
| PK-AF-1250 | 1250 | 1320 | 1400 | 15 | 13 | 20 | 10 | 1500 | 1700 | 340 | 107.0 |

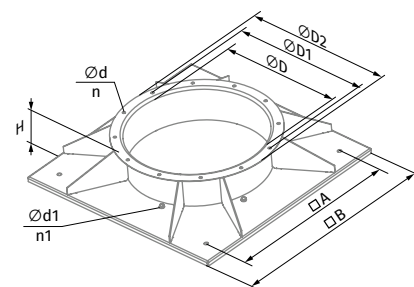

INLET CONE VK-AF

- The inlet cone is recommended to be installed upstream of the fan to improve the air flow parameters. However, it must be installed in the absence of ducting attached to the fan inlet. The inlet cone helps reduce the fan dynamic pressure and increase the static component of the total fan pressure. The unit can be used in combination with the **SZ-AF** protective mesh which must be one size larger than the unit.
- The unit has two flanges and is made of steel with a polymer coating.

| Model | Dimensions [mm] | | | | | | | | | | | Weight [kg] |
|------------|-----------------|------|------|----|----|------|------|------|-----|-----|----|-------------|
| | ØD | ØD1 | ØD2 | Ød | n | ØF | ØF1 | ØF2 | H | Ød1 | n | |
| VK-AF-400 | 400 | 450 | 490 | 8 | 12 | 450 | 500 | 540 | 95 | 8 | 12 | 2.7 |
| VK-AF-450 | 450 | 500 | 540 | 8 | 12 | 500 | 560 | 600 | 110 | 12 | 12 | 3.3 |
| VK-AF-500 | 500 | 560 | 600 | 12 | 12 | 560 | 620 | 660 | 120 | 12 | 12 | 4.0 |
| VK-AF-560 | 560 | 620 | 660 | 12 | 12 | 630 | 690 | 730 | 135 | 12 | 12 | 4.65 |
| VK-AF-630 | 630 | 690 | 730 | 12 | 12 | 710 | 770 | 810 | 150 | 12 | 16 | 6.8 |
| VK-AF-710 | 710 | 770 | 810 | 12 | 16 | 800 | 860 | 900 | 170 | 12 | 16 | 12 |
| VK-AF-800 | 800 | 860 | 900 | 12 | 16 | 900 | 970 | 1015 | 190 | 15 | 16 | 15 |
| VK-AF-900 | 900 | 970 | 1015 | 15 | 16 | 1000 | 1070 | 1115 | 210 | 15 | 16 | 21 |
| VK-AF-1000 | 1000 | 1070 | 1115 | 15 | 16 | 1120 | 1190 | 1270 | 240 | 15 | 20 | 36.7 |
| VK-AF-1120 | 1120 | 1190 | 1270 | 15 | 20 | 1250 | 1320 | 1400 | 255 | 15 | 20 | 45 |
| VK-AF-1250 | 1250 | 1320 | 1400 | 15 | 20 | 1400 | 1470 | 1550 | 285 | 15 | 20 | 53.5 |

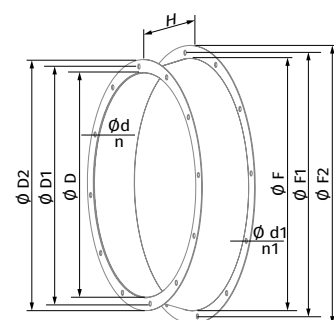

*If PK-AF is used together with other accessories, for example F-AF, EVAF-AF, VRV-AF, attachment of the accessories is done through the holes marked with Ø d1. If no additional accessories are used, the holes marked with Ø d1 must be sealed in any way that prevents water penetration.